



Coopers Meadow Keresley End, Coventry, CV7 8RL Offers over £130,000

Evans Estates is delighted to present this charming two-bedroom ground floor flat located in the desirable area of Coopers Meadow, Keresley End, Coventry. This well-appointed apartment offers a comfortable living space, ideal for individuals or small families seeking a modern home.

Upon entering, you are welcomed by a spacious entrance hall that leads to a bright and airy lounge, perfect for relaxation or entertaining guests. The open-plan design seamlessly connects the lounge to the kitchen, creating a warm and inviting atmosphere. The flat features two well-sized bedrooms, with one benefiting from an en suite bathroom, providing added convenience and privacy.

The property is equipped with electric heating and double glazing, ensuring a cosy environment throughout the year. Externally, residents will appreciate the convenience of an allocated parking space, making daily life that little bit easier.

With approximately 138 years remaining on the lease, this flat presents a fantastic opportunity for both first-time buyers and investors alike. The ground rent is set at £437.00 per calendar year, while the service charge amounts to £1,702.00 annually, covering the maintenance of communal areas and services.

Viewing

Please contact our Evans Estates Office on 02476333363 if you wish to arrange a viewing appointment for this property or require further information.



2



2



1



Floor Plan

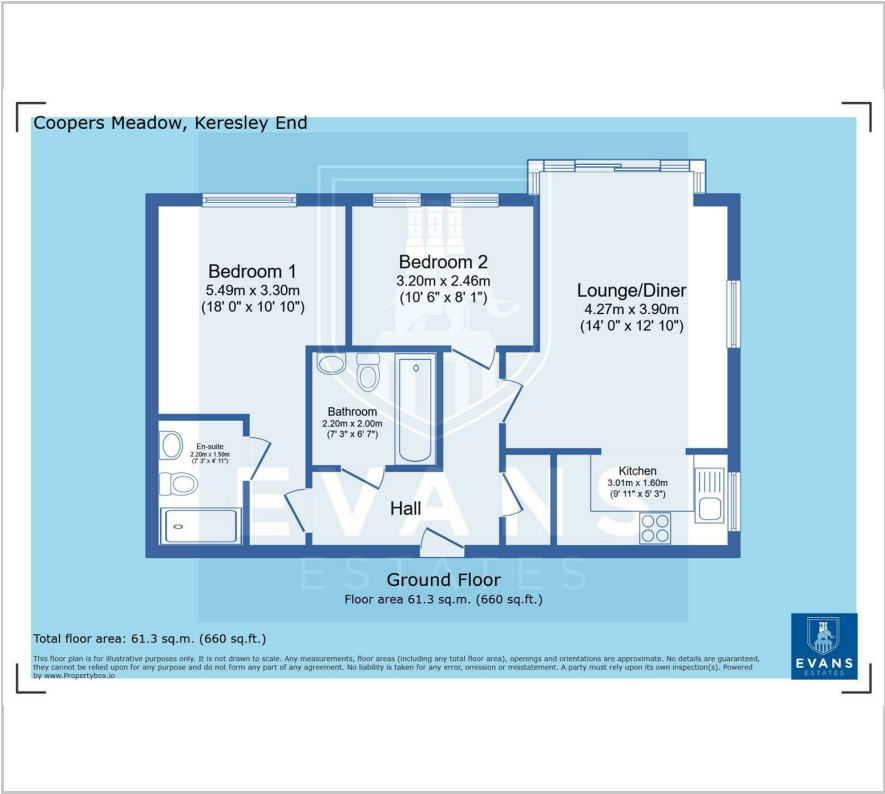

Area Map



Energy Efficiency Graph

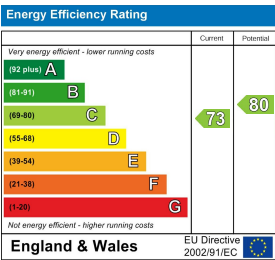

These particulars, whilst believed to be accurate are set out as a general outline only for guidance and do not constitute any part of an offer or contract. Intending purchasers should not rely on them as statements of representation of fact, but must satisfy themselves by inspection or otherwise as to their accuracy. No person in this firms employment has the authority to make or give any representation or warranty in respect of the property.